

STANDARD HANDRAIL SUPPLIED ON ONE SIDE ONLY.  
HANDRAIL BRACKETS INSTALLED AS STANDARD ON  
BOTH SIDES TO ENABLE INSTALLER TO CHANGE  
HANDRAIL SIDES OR PURCHASE AND INSTALL AN  
ADDITIONAL HANDRAIL.

TELESCOPIC HANDRAIL:  
MAY REQUIRE TRIMMING TO AVOID  
CONTACT WITH VERTICAL SURFACE

VERTICAL SURFACE

A PACKER (ILLUSTRATED) OF APPROX. 50mm WILL BE  
REQUIRED WHERE THE VERTICAL FIXING SURFACE EXCEEDS  
THE HEIGHT OF THE BACKBOARD TO A POINT WHERE THE  
LADDER WOULD FOUL AGAINST THE SURFACE WHEN  
STOWED. PACKER AVAILABLE AS AN OPTIONAL ACCESSORY.  
CONTACT US FOR DETAILS.

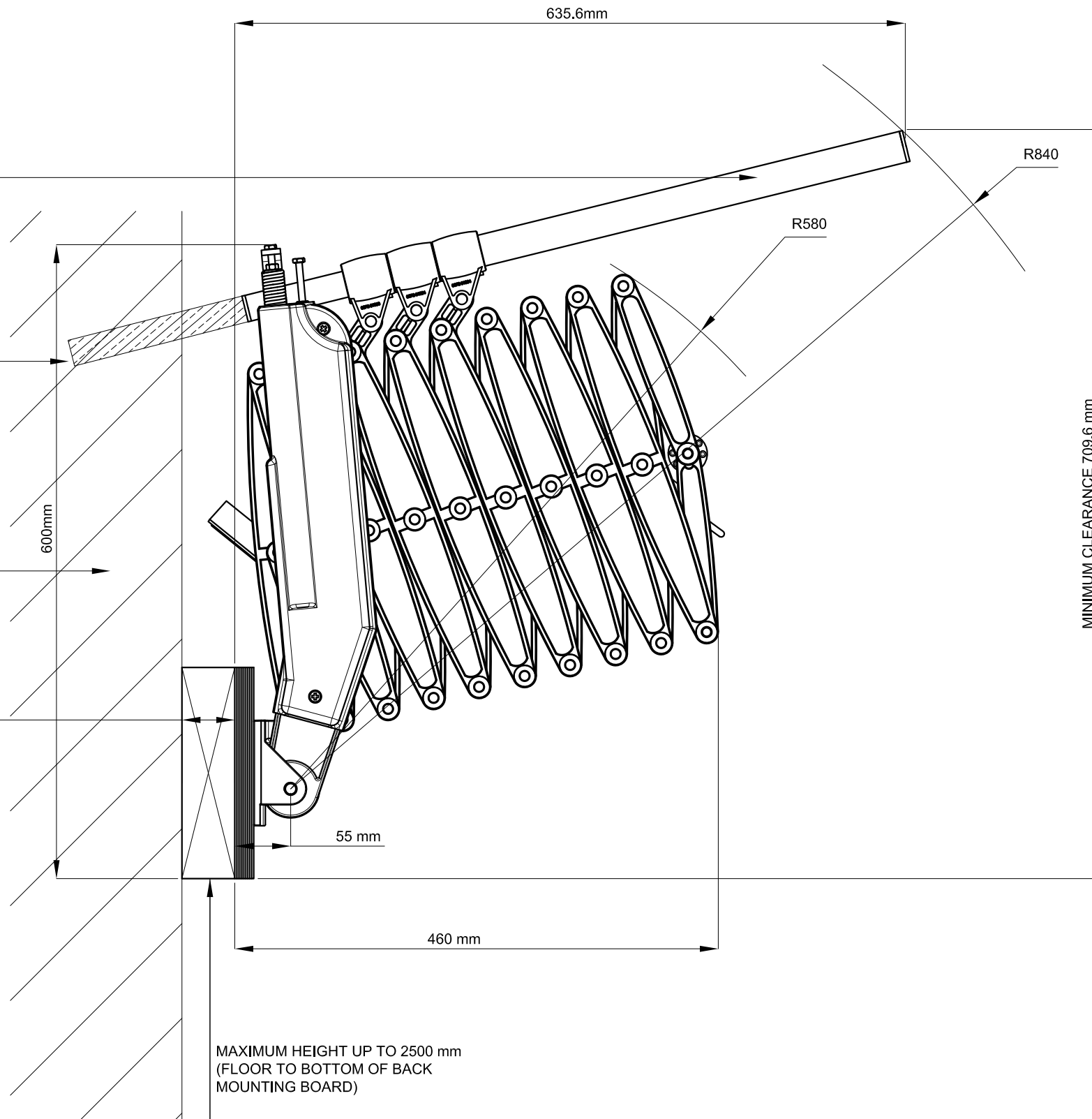

NOTE:  
IT IS RECOMMENDED THAT THE MINIMUM STRUCTURAL OPENING LENGTH  
IS 1000 mm FOR AN ELITE STAIRWAY INSTALLED WITH A HANDRAIL.

PREMIER LOFT LADDERS  
2 Dawson Drive  
Trimley St. Mary  
Felixstowe  
Suffolk  
IP11 0YW  
  
www.premierloftladders.co.uk  
Tel: 0845 9000 195  
Fax: 01394 214413



Issue status:			
Issue	Description	Date	Name
D	Text and handrail mod's	07/2017	J.P.
C	Add standard handrail	08/2016	J.P.
B	Logo change	08/2014	J.P.
A	Addition of packer text	09/2013	J.P.
	First issue	10/2012	J.P.

Drawing Title:  
**ELITE STAIRWAY: 9 treads  
FITTING TO VERTICAL  
SURFACE**

Scale:  
**1:1**  
Sheet:  
PLOT AT  
A3 1:5  
Issue:  
**D**

All dimensions in mm  
© All rights reserved Report all discrepancies Do not scale drawings  
Filename: ELITE9 VERT HANDRAIL.DWG | Project: Standard Issue